

TECHNICAL DATA SHEET

STYLE RX

RING TYPE JOINT GASKET

TME RX

Description

Style TME RX is used in octagonal type grooved flanges. Allowing interchangeability with the joints to improve sealing efficiency. Pressure passage holes are added to RX 82 through RX 91 allowing equalization of pressure.



Style RX

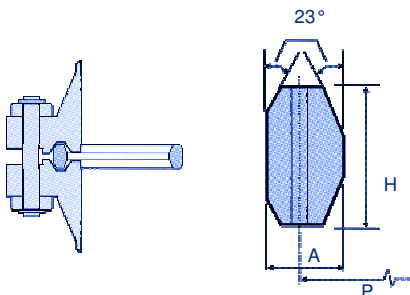

Tolerances: (Inches)	
A (Width of Ring)	± 0.008
B, H (Height of Ring)	± 0.020
P (Ave. Pitch Diameter of Ring)	± 0.007
23° (Angle)	± 1/2°

Available Gasket Material

Material	STANDARD		Maximum Hardness	
	UNS	ASME	Brinell	Rockwell
Soft Iron	-	D	90	56
Low Carbon Steel	-	S	120	68
4-6% Chrome 1/2% Moly (F5)	K42544	F5	130	72
Type 304 Stainless Steel	S30400	S304	160	83
Type 316 Stainless Steel	S31600	S316	160	83
Alloy 321	S32100	S321	217	95
Alloy 625	N06625	INC625	200	93
Alloy 825	N08825	IN825	160	83

TECHNICAL DATA SHEET

STYLE RX RING DIMENSIONS

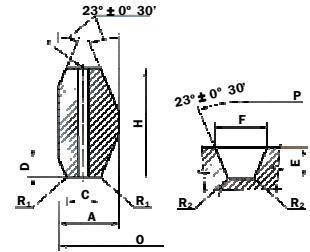

Ring No.	Pipe sizes and pressure class rating for Type RX Ring Gaskets			Pitch diameter of ring (groove)	Outside diameter of ring	Width of ring	Width of flat	Height of outside bevel	Height of ring	Radius in ring	Depth of groove	Width of groove	Radius in groove	Approx. distance between made-up flanges	Weight
	2000	3000	5000	±0.005	+0.02 0	±0.008 0	±0.006 0	0 -0.03	+0.008 0	±0.02	+0.02 0	±0.008	max.		
Dimensions in inches															Lbs
RX-20	1-1/2"	1-1/2"	1-1/2"	2.688	3.000	0.344	0.182	0.125	0.750	0.06	0.25	0.344	0.03	0.38	0.527
RX-23	2"	3.250	3.672	0.469	0.254	0.167	1.000	0.06	0.31	0.469	0.03	0.47	1.150
RX-24	...	2"	2"	3.750	4.172	0.469	0.254	0.167	1.000	0.06	0.31	0.469	0.03	0.47	1.330
RX-25	3-1/8"	4.000	4.313	0.344	0.182	0.125	0.750	0.06	0.25	0.344	0.03	...	1.420
RX-26	2-1/2"	4.000	4.406	0.469	0.254	0.167	1.000	0.06	0.31	0.469	0.03	0.47	1.500
RX-27	...	2-1/2"	2-1/2"	4.250	4.656	0.469	0.254	0.167	1.000	0.06	0.31	0.469	0.03	0.47	1.730
RX-31	3"	3"	...	4.875	5.297	0.469	0.254	0.167	1.000	0.06	0.31	0.469	0.03	0.47	1.910
RX-35	3"	5.375	5.797	0.469	0.254	0.167	1.000	0.06	0.31	0.469	0.03	0.47	2.090
RX-37	4"	4"	...	5.875	6.297	0.469	0.254	0.167	1.000	0.06	0.31	0.469	0.03	0.47	2.270
RX-39	4"	6.375	6.797	0.469	0.254	0.167	1.000	0.06	0.31	0.469	0.03	0.47	2.540
RX-41	5"	5"	...	7.125	7.547	0.469	0.254	0.167	1.000	0.06	0.31	0.469	0.03	0.47	2.720
RX-44	5"	7.625	8.047	0.469	0.254	0.167	1.000	0.06	0.31	0.469	0.03	0.47	2.960
RX-45	6"	6"	...	8.313	8.734	0.469	0.254	0.167	1.000	0.06	0.31	0.469	0.03	0.47	3.660
RX-46	6"	8.313	8.750	0.531	0.263	0.188	1.125	0.06	0.38	0.531	0.06	0.47	8.560
RX-47	(8")	9.000	9.656	0.781	0.407	0.271	1.625	0.09	0.50	0.781	0.06	0.91	3.790
RX-49	8"	8"	...	10.625	11.047	0.469	0.254	0.167	1.000	0.06	0.31	0.469	0.03	0.47	5.360
RX-50	8"	10.625	11.156	0.656	0.335	0.208	1.250	0.06	0.44	0.656	0.06	0.47	4.560
RX-53	10"	10"	...	12.750	13.172	0.469	0.254	0.167	1.000	0.06	0.31	0.469	0.030	0.47	6.450
RX-54	10"	12.750	13.281	0.656	0.335	0.208	1.250	0.06	0.44	0.656	0.060	0.47	5.360
RX-57	12"	12"	...	15.000	15.422	0.469	0.254	0.167	1.000	0.06	0.31	0.469	0.03	0.47	26.400
RX-63	14"	16.500	17.391	1.063	0.582	0.333	2.000	0.09	0.63	1.063	0.09	0.84	6.630
RX-65	16"	18.500	18.922	0.469	0.254	0.167	1.000	0.06	0.31	0.469	0.03	0.47	9.390

TECHNICAL DATA SHEET

STYLE RX RING DIMENSIONS

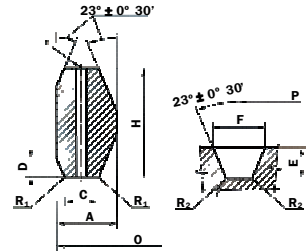

Continued...

Ring No.	Pipe sizes and pressure class rating for Type RX Ring Gaskets			Pitch diameter of ring (groove)	Outside diameter of ring	Width of ring	Width of flat	Height of outside bevel	Height of ring	Radius in ring	Depth of groove	Width of groove	Radius in groove	Approx. distance between made-up flanges	Weight
	API (PSI)			±0.005	+0.02 0	±0.008 0	±0.006 0	0 -0.03	+0.008 0	±0.02	+0.02 0	±0.008	max.		
	2000	3000	5000	Dimensions in inches											Lbs
RX-66	...	16"	...	18.500	19.031	0.656	0.335	0.208	1.250	0.06	0.44	0.656	0.06	0.47	7.52
RX-69	18"	21.000	21.422	0.469	0.254	0.167	1.000	0.06	0.31	0.469	0.03	0.47	20.14
RX-70	...	18"	...	21	21.656	0.781	0.407	0.271	1.625	0.09	0.5	0.781	0.06	0.72	11.63
RX-73	20"	23.000	23.469	0.531	0.263	0.208	1.250	0.06	0.38	0.531	0.06	0.59	22.10
RX-74	...	20"	...	23.000	23.656	0.781	0.407	0.271	1.625	0.09	0.50	0.781	0.06	0.72	0.790
RX-82	2.250	2.672	0.469	0.254	0.167	1.000	0.06	0.31	0.469	0.03	0.47	0.880
RX-84	2.500	2.922	0.469	0.254	0.167	1.000	0.06	0.31	0.469	0.03	0.47	0.880
RX-85	3.125	3.547	0.531	0.263	0.167	1.000	0.06	0.38	0.531	0.06	0.38	1.79
RX-86	3.563	4.078	0.594	0.335	0.188	1.125	0.06	0.44	0.656	0.06	0.38	1.98
RX-87	3.938	4.453	0.594	0.335	0.188	1.125	0.06	0.44	0.656	0.06	0.38	3.22
RX-88	4.875	5.484	0.688	0.407	0.208	1.250	0.06	0.50	0.781	0.06	0.38	2.98
RX-89	4.500	5.109	0.719	0.407	0.208	1.250	0.06	0.50	0.781	0.06	0.38	6.82
RX-90	6.125	6.875	0.781	0.479	0.292	1.750	0.09	0.56	0.906	0.06	0.72	17.10
RX-91	10.250	11.297	1.188	0.780	0.297	1.781	0.09	0.69	1.313	0.09	0.75	3.31
RX-99	(8")	(8")	...	9.250	9.672	0.469	0.254	0.167	1.000	0.06	0.31	0.469	0.03	0.47	...
RX-201	1-3/8"	1.813	2.026	0.226	0.126	0.057 ^b	0.445	0.02 ^c	0.16	0.219	0.03
RX-205	1-13/16"	2.250	2.453	0.219	0.120	0.072 ^b	0.437	0.02 ^c	0.16	0.219	0.02
RX-210	2-9/16"	3.500	3.844	0.375	0.231	0.125 ^b	0.750	0.03 ^c	0.25	0.375	0.03
RX-215	4-1/16"	5.125	5.547	0.469	0.210	0.167 ^b	1.000	0.06 ^c	0.31	0.469	0.03

^a The pressure passage hole illustrated in the RX ring cross section applies to rings RX-82 through RX-91 only. Centerline of hole shall be located at mid point of dimension C. Hole diameter shall be 0.06 inches for rings RX-82 through RX-85, 0.09 inches for rings RX-86 and RX-87, and 0.12 inches for rings RX-88 through RX-91.

^b Tolerance on these dimensions is +0, - 0.015

^c Tolerance on these dimensions is +0.02, +0

^d A plus tolerance of 0.008 inches for width A and height H is permitted, provided the variation in width or height of any ring does not exceed 0.004 inches through its entire circumference.

(8") Denotes crossover flange connection.