

TECHNICAL DATA SHEET

STYLE BX

RING TYPE JOINT GASKET

TME BX

Description

All BX energized gaskets manufactured to API 6A incorporate a pressure passage hole, allowing equalization of pressure between grooves.



Style BX

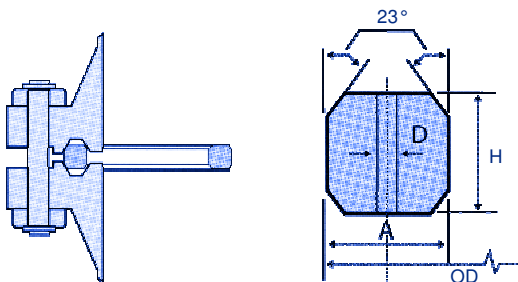

Tolerances: (Inches)	
A (Width of Ring)	+ 0.008, - 0.000
D (Hole Size)	± 0.002
H (Height of Ring)	+ 0.008, - 0.000
OD (OD of Ring)	+ 0.000, - 0.006
23° (Angle)	± ¼°

Available Gasket Material

Material	STANDARD		Maximum Hardness	
	UNS	ASME	Brinell	Rockwell
Soft Iron	-	D	90	56
Low Carbon Steel	-	S	120	68
4-6% Chrome ½% Moly (F5)	K42544	F5	130	72
Type 304 Stainless Steel	S30400	S304	160	83
Type 316 Stainless Steel	S31600	S316	160	83
Alloy 321	S32100	S321	217	95
Alloy 625	N06625	INC625	200	93
Alloy 825	N08825	IN825	160	83

TECHNICAL DATA SHEET

STYLE BX RING DIMENSIONS

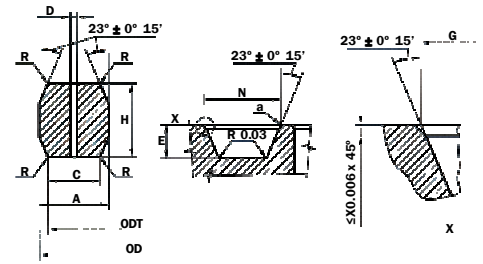

Ring No.	Pipe sizes & pressure class rating for type BX ring gaskets						Outside diameter of ring	Height of ring	Width of ring	Diameter of flat	Width of flat	Hole size	Depth of groove	Outside diameter of groove	Width of groove	Weight
	API (PSI)						OD	H ^b	A ^b	ODT	C	D	E	G	N	Lbs
							0 -0.006	+0.008 0	+0.008 0	±0.002	+0.006 0	±0.02	+0.02 0	+0.004 0	+0.004 0	
	2000	3000	5000	10000	15000	20000	Dimensions in inches									
BX-150	1-11/16"	1-11/16"	...	2.842	0.366	0.366	2.790	0.314	0.06	0.22	2.893	0.450	0.30
BX-151	1-13/16"	1-13/16"	1-13/16"	3.008	0.379	0.379	2.954	0.325	0.06	0.22	3.062	0.466	0.34
BX-152	2-1/16"	2-1/16"	2-1/16"	3.334	0.403	0.403	3.277	0.346	0.06	0.23	3.395	0.498	0.42
BX-153	2-9/16"	2-9/16"	2-9/16"	3.974	0.448	0.448	3.910	0.385	0.06	0.27	4.046	0.554	0.63
BX-154	3-1/16"	3-1/16"	3-1/16"	4.600	0.488	0.488	4.531	0.419	0.06	0.30	4.685	0.606	0.88
BX-155	4-1/16"	4-1/16"	4-1/16"	5.825	0.560	0.560	5.746	0.481	0.06	0.33	5.930	0.698	1.22
BX-156	7-1/16"	7-1/16"	7-1/16"	9.367	0.733	0.733	9.263	0.629	0.12	0.44	9.521	0.921	4.14
BX-157	9"	9"	9"	11.593	0.826	0.826	11.476	0.709	0.12	0.50	11.774	1.039	6.55
BX-158	11"	11"	11"	13.860	0.911	0.911	13.731	0.782	0.12	0.56	14.064	1.149	9.60
BX-159	13-5/8"	13-5/8"	13-5/8"	16.800	1.012	1.012	16.657	0.869	0.12	0.62	17.033	1.279	14.41
BX-160	13-5/8"	15.850	0.938	0.541	15.717	0.408	0.12	0.56	16.063	0.786	6.75
BX-161	16-3/4"	19.347	1.105	0.638	19.191	0.482	0.12	0.67	19.604	0.930	11.50
BX-162	16-3/4"	16-3/4"	16-3/4"	...	18.720	0.560	0.560	18.641	0.481	0.06	0.33	18.832	0.705	5.00
BX-163	18-3/4"	21.896	1.185	0.684	21.728	0.516	0.12	0.72	22.185	1.006	14.50
BX-164	18-3/4"	18-3/4"	...	22.463	1.185	0.968	22.295	0.800	0.12	0.72	22.752	1.290	21.50
BX-165	21-1/4"	24.595	1.261	0.728	24.417	0.550	0.12	0.75	24.904	1.071	19.00
BX-166	21-1/4"	25.198	1.261	1.029	25.020	0.851	0.12	0.75	25.507	1.373	27.50
BX-167	26-3/4"	29.896	1.412	0.516	29.696	0.316	0.06	0.84	30.249	0.902	17.00
BX-168	...	26-3/4"	30.128	1.412	0.632	29.928	0.432	0.06	0.84	30.481	1.018	
BX-169	5-1/8"	6.831	0.624	0.509	6.743	0.421	0.06	0.38	6.955	0.666	1.76
BX-170	6-5/8"	6-5/8"	...	8.584	0.560	0.560	8.505	0.481	0.06	0.33	8.696	0.705	2.23
BX-171	8-9/16"	8-9/16"	...	10.529	0.560	0.560	10.450	0.481	0.06	0.33	10.641	0.705	
BX-172	11-5/32"	11-5/32"	...	13.113	0.560	0.560	13.034	0.481	0.06	0.33	13.225	0.705	
BX-303	30"	30"	33.573	1.494	0.668	33.361	0.457	0.06	0.89	33.949	1.078	

Radius R shall be 8% to 12% of the gasket height H. One pressure-passage hole required per gasket on centerline.

^a Break sharp corner on inside diameter of groove.

^b A plus tolerance of 0.088 in for width of A and height H is permitted, provided the variation in width or height of any ring does not exceed 0.004 in throughout its entire circumference